

A volunteer is needed at each service to put the correct slide on the screens at the right time. The services are set up on the computer prior to the service by the Director of Technology. Advancing the slides for the screens is not complicated. There are only a few buttons to learn. A second volunteer is needed at the sound board during services when the praise group leads the music or when other special music is done.

A third volunteer is needed to operate the cameras for the service being recorded and for other special services.

***Please consider helping in this area!***

Training is available at any time on any of the equipment.

Contact the Director of Technology at 338-5626 or at [technology@ourredeemer.org](mailto:technology@ourredeemer.org)

## USHERS

Ushers are an important part of our Sunday services. They distribute worship bulletins and other worship aids prior to the services. Ushers also assist in gathering the offering and distributing communion. Five ushers participate in each service. Ushers volunteer to serve regularly at one service per month. Contact Dave Freundt (338-5546).

## Administrative Connections:



### BEACON

Our monthly church newsletter “Beacon” is our overall guide to the month’s news, activities, and calendar within the Body of Christ here at Our Redeemer.

The name of the newsletter comes from Matthew 5:14 *You are the light of the world. A city on a hill cannot be hidden.* Notice the skylight at the top of the sanctuary. From this place, we shine our Gospel light into the community. Not just the building, but we the people are the light in this community.

***We encourage regular reading of this publication.***

The Beacon is mailed out once a month, and is also located online at [www.ourredeemer.org](http://www.ourredeemer.org).

Submissions are due to the church office no later than 5 p.m. on the 16th of each month. Contact our Office Manager Sally Trimpe.

### CARD SHOP AND BOOKSTORE

LWML hosts a Christian card shop and bookstore located just outside the fellowship hall on the lower level of the church. This service is available to provide low-cost Christian messages of hope, concern, encouragement and joy.

In addition to cards, there are Christian resources (Bibles, bookmarks, napkins, jewelry, and small gifts) available. These resources will be ordered.

Payment box is located in the church office on the upper level. For more information, contact Cynthia Freundt at 338-5546.

## **COMMUNICATION CABINETS**

To provide a way to stay in communication with one another, each member family of Our Redeemer is assigned a communication box located just outside the church office.

If you do not yet have a box assigned to your family or you have further questions, please contact our Office Manager Sally Trimpe at 338-5626.

## **COMMUNICATION RACKS**

Previous and current issues of Beacon, Reflections, Sermon Notes, IDE Today, Lutheran Digest, and other important communications can be found on communication racks outside the church office and in the church library.

## **DEVOTIONS**

Many resources are available to help with personal and group devotions. Copies of Portals of Prayer, My Devotions, and Happy Times can be found in the narthex.

Devotional materials can also be found in the church library.

Links to online devotions are available on our church website [www.ourredeemer.org](http://www.ourredeemer.org).

If you need assistance finding the right materials for you, contact the church office at 338-5626.

## **LIBRARY**

The church library, a free service organized by members of LWML, provides quality Christian books, movies, cassette tapes and CDs to assist members of all ages in their faith journey. A card system is utilized for check-in/check-out.

Please stop by the desk in the library when checking in or out materials. If you have questions, please contact Rita Johnson at 358-8972.

## **REFLECTIONS**

Our weekly church newsletter "Reflections" helps us reflect on how God is working within the Body of Christ here at Our Redeemer.

We encourage regular reading up on the most up-to-date information in this publication.

Reflections can be found at the ushers table at weekend worship, or located online at [www.ourredeemer.org](http://www.ourredeemer.org).

Submissions are due to the church office no later than noon each Wednesday. Contact our Office Manager Sally Trimpe at 338-5626.

# Map of Classrooms

Our Redeemer Lutheran Church  
Iowa City, IA

## First Floor

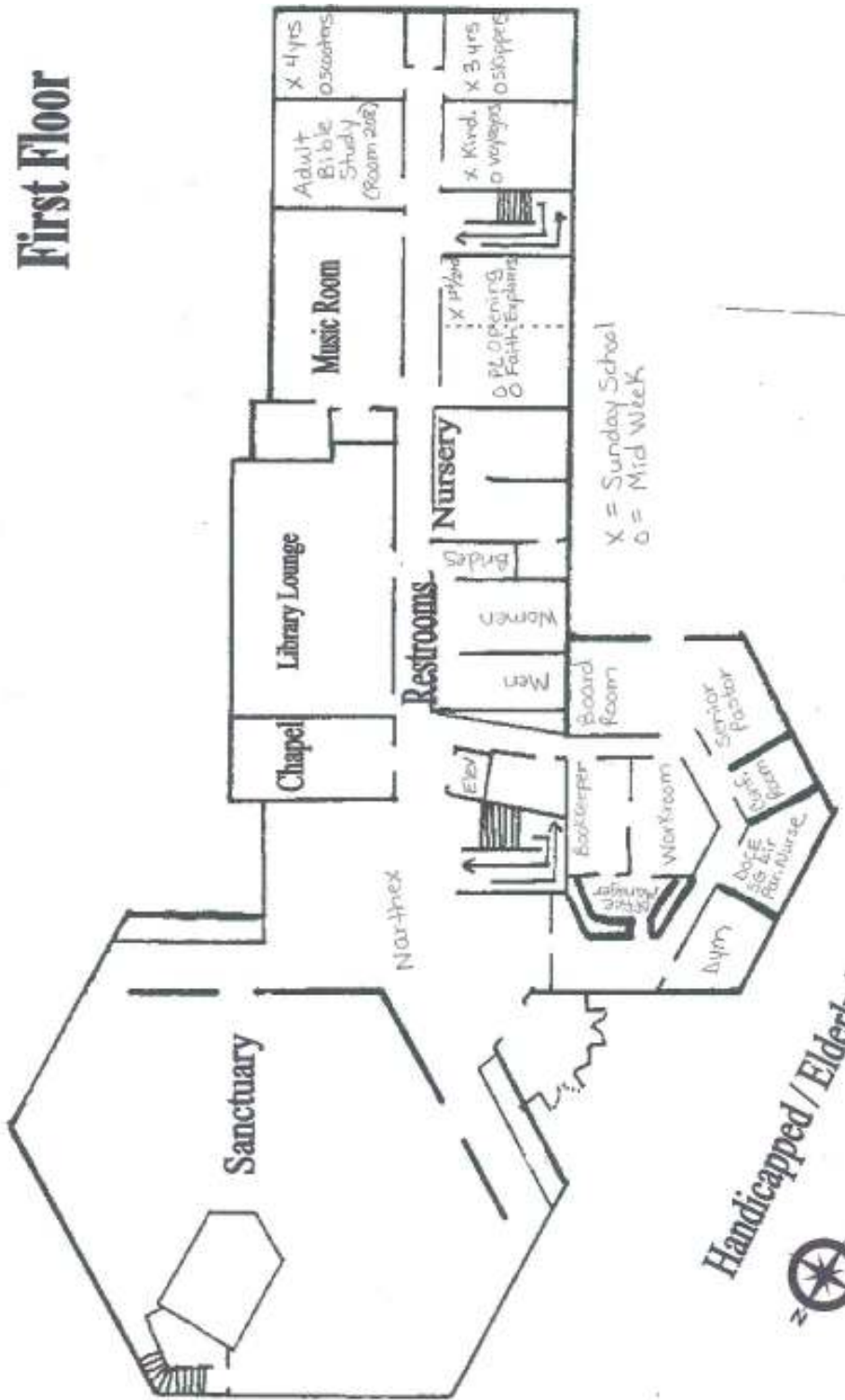

**Our Redeemer Lutheran Church**  
Iowa City, IA

**Ground Floor**

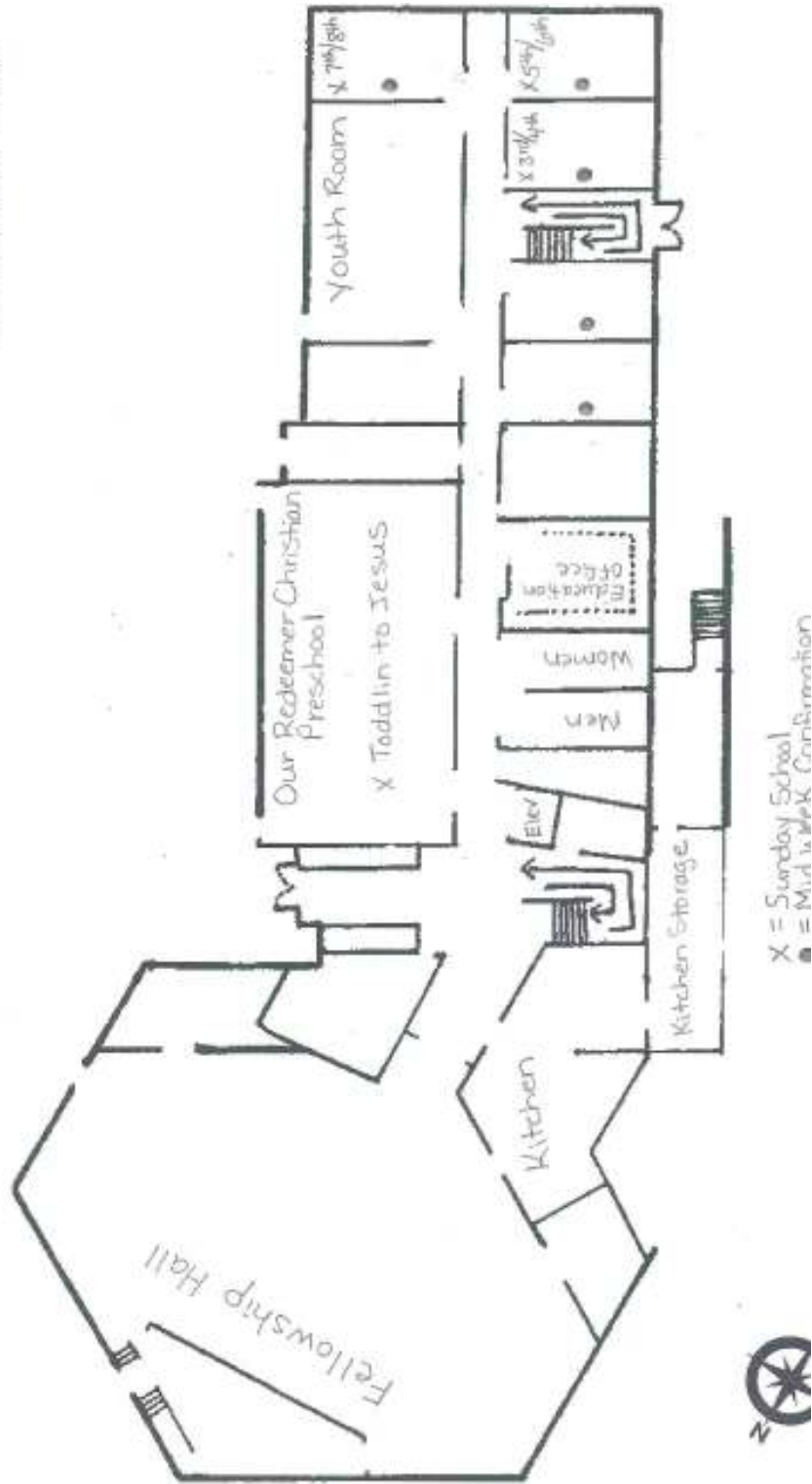

**Children's Ministry Programs and Resources  
Our Redeemer Lutheran Church, Iowa City, IA**

	Birth -- 1 yr	2 yrs	3 yrs	4 yrs	Kind	1 <sup>st</sup>	2 <sup>nd</sup>	3 <sup>rd</sup>	4 <sup>th</sup>	5 <sup>th</sup>	6 <sup>th</sup>	7 <sup>th</sup>	8 <sup>th</sup>
<b>CLASSES</b>													
Toddlin' to Jesus	X	X											
Sunday School			X	X	X	X	X	X	X	X	X	X	X
Pioneer Club		X	X	X	X	X	X	X	X	X	X	X	X
Faith Explorers								X	X	X	X	X	X
Confirmation											X	X	X
<b>GROUPS</b>													
ORKS (Our Redeemer Kids)										X	X	X	X
<b>SPECIALS</b>													
CFN Meals	X	X	X	X	X	X	X	X	X	X	X	X	X
Backpacking with Jesus	X	X	X	X	X	X	X	X	X	X	X	X	X
Christmas Program			X	X	X	X	X	X	X	X	X	X	X
Vacation Bible School			X	X	X	X	X	X	X	X	X	X	X
<b>RESOURCES</b>													
Cradle Roll	**	**											
Picture Bible			X										
Children's Bible						X							
Devotions Book								X					
Study Bible & Catechism												X	

\*\*When a child is baptized, they are automatically enrolled in Cradle Roll until their 3<sup>rd</sup> birthday.

EXTRA ACTIVITIES: Easter Egg Hunt, Spring Carnival, Coralville Independence Day Parade, Trunk or Treat, and other activities as scheduled.

**Youth Ministry Programs**  
Our Redeemer Lutheran Church, Iowa City, IA

	5 <sup>th</sup>	6 <sup>th</sup>	7 <sup>th</sup>	8 <sup>th</sup>	9 <sup>th</sup>	10 <sup>th</sup>	11 <sup>th</sup>	12 <sup>th</sup>
<b>CLASSES</b>								
Sunday School	X	X	X	X	X	X	X	X
Faith Explorers	X							
Confirmation		X	X	X				
GAP (God's Almighty Promises)					X	X	X	X
<b>GROUPS</b>								
ORKS (Our Redeemer Kids)	X	X	X	X				
LYF (Lutheran Youth Fellowship)					X	X	X	X
Youth Committee	X	X	X	X	X	X	X	X
<b>SPECIALS</b>								
Church Family Night	X	X	X	X	X	X	X	X
Summer Stretch (mission)	X	X	X	X	X			
Youth Worship Service	X	X	X	X	X	X	X	X
Christmas Program	X	X	X	X				
Living Nativity					X	X	X	X
VBS participation/help / teach	X	X	X	X				
Valentines Day (mission)	X	X	X	X				
Servant Event / Youth Gathering					X	X	X	X
Confirmation Retreats (2 /year)		X	X	X				
Lock-In	X	X	X	X	X	X	X	X
Lock-Out				X	X	X	X	X
Christmas / Epiphany Party	X	X	X	X	X	X	X	X
Family Ski Trip & Roller-skating	X	X	X	X	X	X	X	X
Devotions Book (Grad. Present)								X
<b>FUNDRAIZORS</b>								
Peaches	X	X	X	X	X	X	X	X
Recycling Ink cartridges	X	X	X	X	X	X	X	X

\*\*All ORKS and LYF youth receives a Birthday Postcard within their birthday month.

**OTHER:**

April / May	Welcome to ORKS / LYF Night
July	Coralville Independence Day Parade
October	Trunk or Treat
November	College Care Packages
Dec/Feb	ORKS/LYF Serve an Advent or Lenten Meal
YEAR	ORKS/LYF Serve Coffee & Treats to congregation